

**Prepared By:**

Michael D. Downing  
Miller, Forest & Downing, Ltd.  
1275 Milwaukee Ave., Suite 300  
Glenview, Illinois 60025

**Return Recorded  
Document To:**

Michael D. Downing  
Miller, Forest & Downing, Ltd.  
1275 Milwaukee Ave., Suite 300  
Glenview, Illinois 60025

**ORDINANCE NO. 179**

**AN ORDINANCE TO ANNEX CERTAIN TERRITORY TO THE  
NORTHFIELD WOODS SANITARY DISTRICT,  
COOK COUNTY, ILLINOIS**

WHEREAS, the President and Board of Trustees of the Northfield Woods Sanitary District ("District") have determined that annexation of certain territory, hereinafter legally described on Exhibit A attached hereto and made a part hereof, and colored green, with the existing District boundaries shaded in red on Exhibit B attached hereto and made a part hereof, is in the best interest of the Northfield Woods Sanitary District and will promote the public health, safety, comfort, morals, and welfare of the Northfield Woods Sanitary District and its residents; and

WHEREAS, a Petition for Annexation has been submitted to the District signed by the property owners of record requesting annexation to the District and requesting that the District's sewage disposal lines be extended to serve the territory, with the costs to be equally divided amongst the property owners; and

WHEREAS, the President and Board of Trustees of the Northfield Woods Sanitary District have determined that such territory, hereinafter legally described on the attached Exhibit A and colored in green, with the existing District boundaries shaded in red on the attached Exhibit B, is not within the corporate limits of the District, but is contiguous to it and is to be served by the District; and

WHEREAS, a Public Hearing was held on February 2, 1999, and continued until March 2, 1999, to consider the annexation of this territory, with notice of said Public Hearing being published in accordance with applicable statutes.

NOW, THEREFORE, BE IT ORDAINED BY THE PRESIDENT AND BOARD OF TRUSTEES OF THE NORTHFIELD WOODS SANITARY DISTRICT, COOK COUNTY, ILLINOIS:

SECTION 1: That the territory legally described on Exhibit A attached hereto and made a part hereof and colored green, with the existing District boundaries shaded in red on the annexation map attached hereto as Exhibit B, be and the same is hereby annexed to the Northfield Woods Sanitary District, Cook County, Illinois, pursuant to the provisions of Illinois Compiled Statutes, Chapter 70, Section 2805/32a.4 and 32a.4a.

SECTION 2: That this Ordinance shall be effective upon its passage and approval according to law.

SECTION 3: That the attorney for the Northfield Woods Sanitary District is hereby authorized and directed to file with the County Clerk of Cook County a copy of this Ordinance

with an accurate map of the territory annexed, attached hereto and made a part hereof, certified as correct by the Clerk of the Northfield Woods Sanitary District.

**PASSED** this 2<sup>nd</sup> day of March, 1999.

**AYES:** 3

**APPROVED** this 2<sup>nd</sup> day of March, 1999.

**NAYES:** 0

**ABSENT:** 0

**ATTEST:**

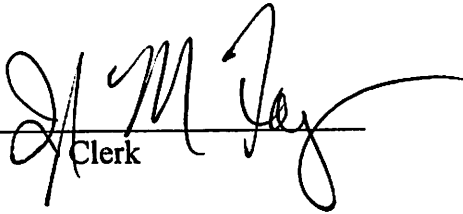
  
\_\_\_\_\_  
Clerk

**APPROVED:**

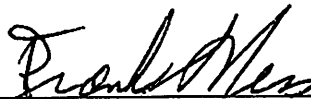
  
\_\_\_\_\_  
President

WW7NWSD2\ORD179

STATE OF ILLINOIS)  
  ) SS.  
COUNTY OF COOK )

CERTIFICATE

I, JOSEPH M. FAGAN, do hereby certify that I am the duly qualified and acting Clerk of the Board of Trustees of the NORTHFIELD WOODS SANITARY DISTRICT in the state and county aforesaid, and as said Clerk, I am the keeper of records and files of the Board of Trustees of said Sanitary District.

I do further certify that the foregoing is a full, true and complete copy of Ordinance No. 179, entitled, "AN ORDINANCE TO ANNEX CERTAIN TERRITORY TO THE NORTHFIELD WOODS SANITARY DISTRICT, COOK COUNTY, ILLINOIS", adopted at the regular meeting of the Board of Trustees of said Sanitary District held on the 2<sup>nd</sup> day of March, 1999.

  
\_\_\_\_\_  
Clerk, Board of Trustees (Seal)

**EXHIBIT A**

Lots 1-8 inclusive in Pleasant Plains, a subdivision of part of the East 64 acres of the North 124 acres of the Northwest ¼ of Section 29, Township 42, Range 12 East of the Third Principal Meridian, in Cook County, Illinois

and

Lots 9, 10, 11, 13, 14, 15, 16, 20, 21, 22 and 23 in Pleasant Plains Unit No. 2, a subdivision of part of the East 64 acres of the North 124 acres of the Northwest ¼ of Section 29, Township 42, Range 12, East of the Third Principal Meridian, in Cook County, Illinois

and

The Lot known as the Park in Pleasant Plains Subdivision Unit #2 being a Subdivision of part of the East 64 acres of the North 124 acres of the Northwest ¼ of Section 29, Township 42 North, Range 12, East of the Third Principal Meridian, according to the plat thereof recorded November 8, 1957 as Document 17060826, all in Cook County, Illinois.

Lot 1, P.I.N.: 04-29-100-065

Commonly known as 3245 Westview Drive, Northbrook, Illinois 60062

Lot 2, P.I.N.: 04-29-100-064

Commonly known as 3255 Westview Drive, Northbrook, Illinois 60062

Lot 3, P.I.N.: 04-29-100-063

Commonly known as 3275 Westview Drive, Northbrook, Illinois 60062

Lot 4, P.I.N.: 04-29-100-059

Commonly known as 3305 Westview Drive, Northbrook, Illinois 60062

Lot 5, P.I.N.: 04-29-100-058

Commonly known as 3372 Overland Pass, Northbrook, Illinois 60062

Lot 6, P.I.N.: 04-29-100-060

Commonly known as 3278 Westview Drive, Northbrook, Illinois 60062

Lot 7, P.I.N.: 04-29-100-061

Commonly known as 3256 Westview Drive, Northbrook, Illinois 60062

Lot 8, P.I.N.: 04-29-100-062

Commonly known as 3227 Westview Drive, Northbrook, Illinois 60062

Lot 9, P.I.N.: 04-29-100-074

Commonly known as 3231 Pleasant Run, Northbrook, Illinois 60062

Lot 10, P.I.N.: 04-29-100-073

Commonly known as 3251 Pleasant Run, Northbrook, Illinois 60062

Lot 11, P.I.N.: 04-29-100-072

Commonly known as 3281 Pleasant Run, Northbrook, Illinois 60062

Lot 13, P.I.N.: 04-29-100-070

Commonly known as 3258 Pleasant Run, Northbrook, Illinois 60062

Lot 14, P.I.N.: 04-29-100-069

Commonly known as 3280 Pleasant Run, Northbrook, Illinois 60062

Lot 15, P.I.N.: 04-29-100-068

Commonly known as 3289 Overland Pass, Northbrook, Illinois 60062

Lot 16, P.I.N.: 04-29-100-067

Commonly known as 3285 Overland Pass, Northbrook, Illinois 60062

Lot 20, P.I.N.: 04-29-100-078

Commonly known as 3300 Overland Pass, Northbrook, Illinois 60062

Lot 21, P.I.N.: 04-29-100-079

Commonly known as 3320 Overland Pass, Northbrook, Illinois 60062

Lot 22, P.I.N.: 04-29-100-080

Commonly known as 3336 Overland Pass, Northbrook, Illinois 60062

Lot 23, P.I.N.: 04-29-100-081

Commonly known as 3360 Overland Pass, Northbrook, Illinois 60062

Park, P.I.N.: 04-29-100-082

Commonly known as the Park in Pleasant Plains Subdivision

# NORTHFIELD WOODS SANITARY DISTRICT



## ANNEXATION MAP

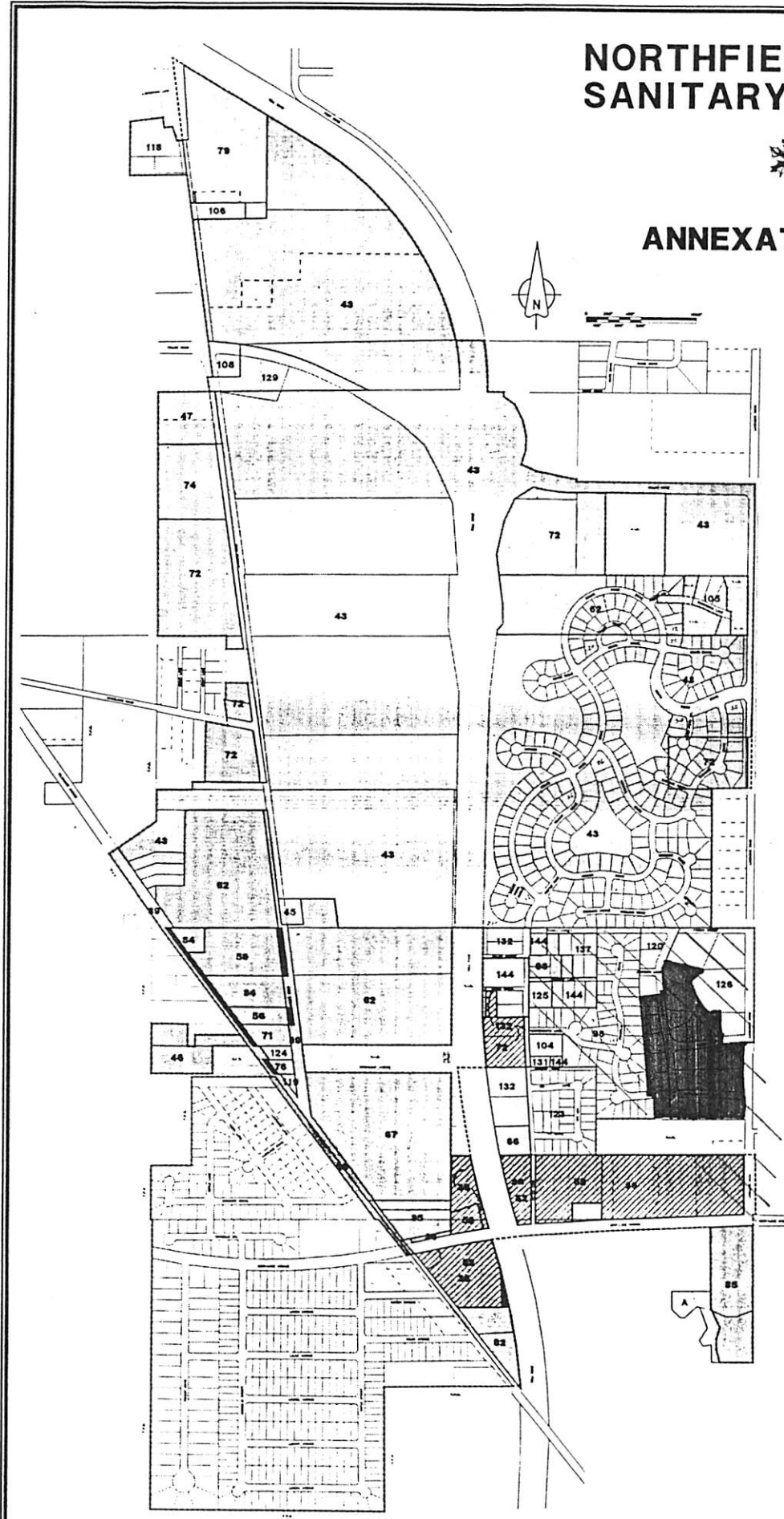

### ANNEXATION ORDINANCES

NO.	DATE	AREA
ORIG. DIST.	MAY 1, 1964	87.21 ACRES
25	NOVEMBER 30, 1965	4.50
26	JUNE 28, 1966	29.55
28	APRIL 25, 1967	13.32
43	JUNE 27, 1967	44.63
45	JANUARY 23, 1968	1.06
46	JANUARY 23, 1968	5.71
47	JANUARY 23, 1968	5.36
52	JUNE 24, 1969	29.26
56	JANUARY 26, 1971	2.03
59	NOVEMBER 23, 1971	7.70
62	DECEMBER 19, 1972	76.61
66	NOVEMBER 27, 1973	1.80
67	MAY 28, 1974	28.11
71	NOVEMBER 26, 1974	1.78
72	APRIL 22, 1975	51.60
74	JUNE 24, 1975	8.83
76	APRIL 27, 1976	0.68
79	APRIL 26, 1977	17.24
82	JULY 26, 1977	4.41
83	OCTOBER 25, 1977	1.86
84	MARCH 13, 1978	5.51
85	APRIL 10, 1978	10.27
93	MARCH 10, 1980	22.48
104	JUNE 14, 1982	1.33
105	JULY 19, 1982	2.58
106	JANUARY 10, 1983	1.61
108	FEBRUARY 14, 1983	1.87
118	AUGUST 11, 1986	5.13
119	AUGUST 11, 1986	0.20
120	OCTOBER 13, 1986	3.61
123	JUNE 8, 1987	11.01
124	AUGUST 12, 1987	0.67
125	JANUARY 11, 1988	1.09
126	JANUARY 11, 1988	12.82
129	JUNE 13, 1988	7.41
131	NOVEMBER 3, 1988	0.28
132	NOVEMBER 3, 1988	11.48
137	AUGUST 14, 1989	2.62
144	JANUARY 30, 1991	8.51

TOTAL DISTRICT AREA = 1,072.81 ACRES

### SERVICE AGREEMENTS

NO.	DESC./DATE	AREA
A	FORCH CHURCH JULY 4, 1976	X
B	BLEWETT PARK DIST. JULY 4, 1976	X

### LEGEND OF SYMBOLS

SYMBOL	DESCRIPTION
—	ORIGINAL DISTRICT BOUNDARY
▨	AREA OF ANNEXATION
▩	AREA OF MULTIPLE ANNEXATION
32	ANNEXATION ORDINANCE NUMBER
▨	AREA OF SPECIAL SERVICE AGREEMENT
---	DISTRICT BOUNDARY
N.D.	NOT IN DISTRICT
F.P.D.	FOREST PRESERVE DISTRICT

NO.	DATE	BY
1984	MAY 1	MFR
1982	DEC 1	MFR
1982	MAY 1	LEV
1981	OCT 1	LEV
1981	MAY 1	DPM
1980	AUG 1	LEV
1980	SEP 1	MEX
1980	SEP 1	MEX
1980	SEP 1	MEX